

# 5TH WHEEL STAR TRAILER



EMERALD GREEN  
IS THE NEW GREEN

100% Solar & Battery Powered Trucks, Trailers and Mobile Power

# SOLAR

## SPECS

**Trailer:** 45' long including tongue  
8'6" wide; 12'2" wide including extended pop-outs  
13'0" high

**Rooms:** 206 sqft Living room (exluding popouts)  
152 sqft bedroom (exluding popouts)

**Stairs:** 2'5" wide, extend 4' from trailer

**Battery Capacity:** 60 kWh  
**Solar Intake:** 5 kW  
**Charger Type:** 50A RV plug  
**Fresh Water Tank Size:** 75 gal.  
**Grey Water Tank Size:** n/a  
**Black Water Tank Size:** 75 gal.

## FEATURES

- Dual zone - mini-split HVAC
- Flat screen TV with streaming channels
- WiFi
- Full size refridgerator
- Microwave & Stove
- Private Bedroom
- Queen-size bed
- Hair & makeup station with dimmable lighting
- Full bathroom
- Full-length mirror

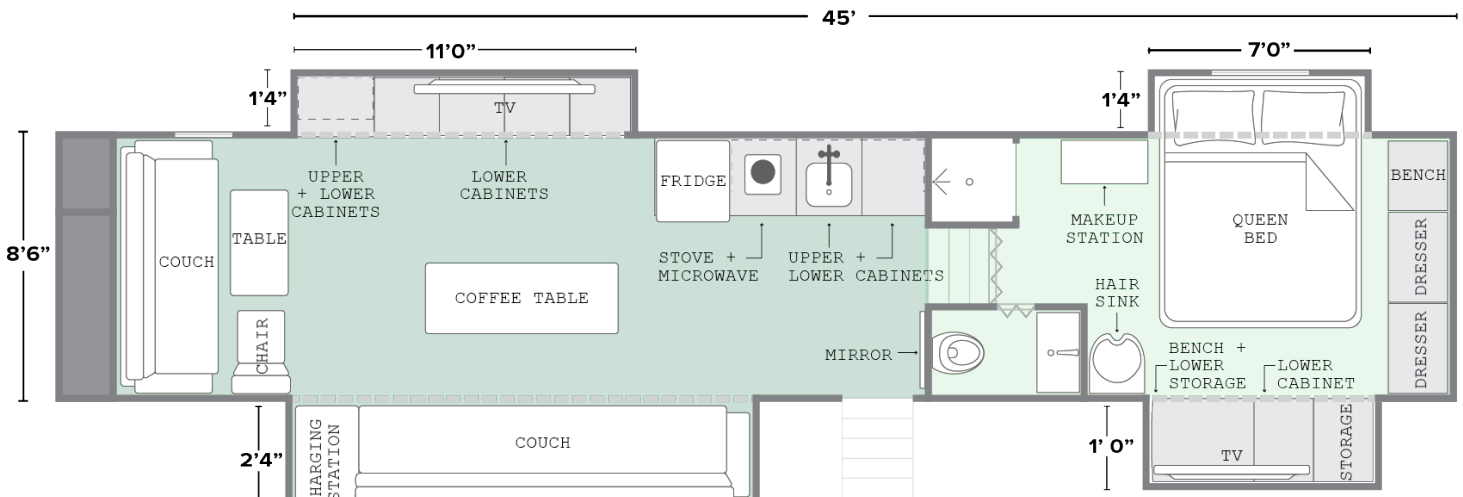

Some trailer layouts may vary.